

1 2
| 2 THRU 14 | | 3 |

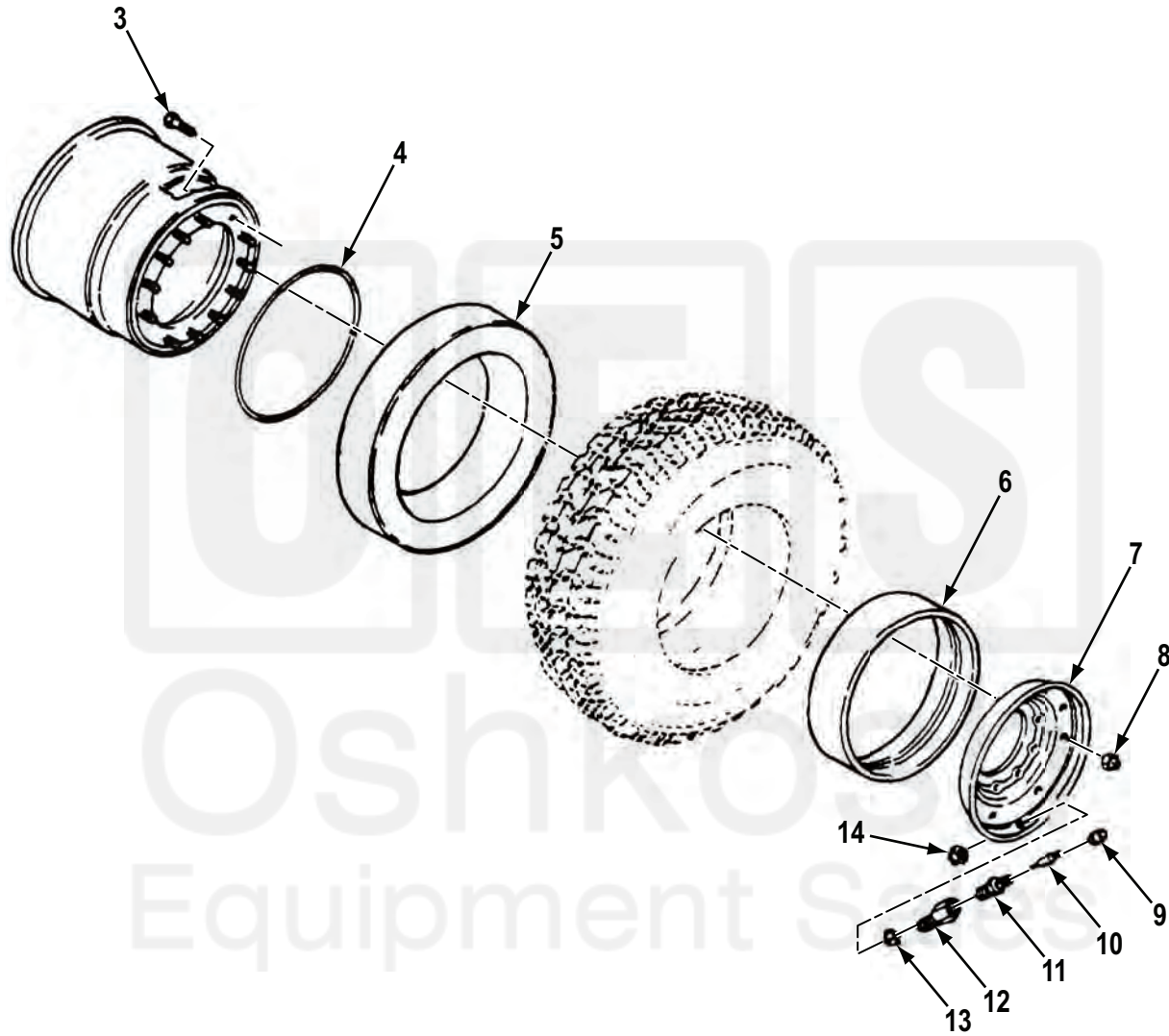

M116 M101 R021

Figure 13. Wheel and Runflat Assembly (M101A3 and M116A3).

(1) ITEM NO.	(2) SMR CODE	(3) NSN	(4) CAGEC	(5) PART NUMBER	(6) DESCRIPTION AND USABLE ON CODE (UOC)	(7) QTY
GROUP 1311 WHEEL ASSEMBLY						
FIG. 13. WHEEL AND RUNFLAT ASSEMBLY (M101A3 AND M116A3).						
1	AFFF		19207	12342641	WHEEL AND RUN FLAT ASSEMBLY RADIAL TIRE. UOC: CT1,TC1	1
2	PAFFF	2530-01-336-5740	19207	12342642	. RIM,WHEEL,PNEUMATIC UOC: CT1,TC1	1
3	PAFZZ	5306-01-336-7175	19207	12342758	. . BOLT,RIBBED NECK UOC: CT1,TC1	12
4	PCFZZ	5331-01-335-8878	19207	12342633	. O-RING UOC: CT1,TC1	1
5	PCFZZ	2640-01-334-9453	19207	12342638	. RUNFLAT,INSERT UOC: CT1,TC1	1
6	PAFZZ	2530-01-338-2730	19207	12342639	. BEADLOCK,TIRE RIM UOC: CT1,TC1	1
7	PAFZZ	2530-01-336-3127	19207	12342640	. RIM,WHEEL,PNEUMATIC UOC: CT1,TC1	1
8	PAFZZ	5310-01-198-7585	19207	12339501	. NUT,SELF-LOCKING,HE UOC: CT1,TC1	12
9	PAFZZ	2640-01-098-2029	39BV2	627-100-GOVT	. CAP,PNEUMATIC VALVE UOC: CT1,TC1	1
10	PAFZZ	2640-00-050-1229	39BV2	100-AA	. VALVE CORE UOC: CT1,TC1	1
11	PAFZZ	2640-01-335-4583	19207	12342634	. VALVE,PNEUMATIC TIR UOC: CT1,TC1	1
12	PAFZZ	4730-01-346-1063	19207	12342793	. ADAPTER,STRAIGHT,PI UOC: CT1,TC1	1
13	PCFZZ	5331-01-346-3806	19207	12342794	. O-RING UOC: CT1,TC1	1
14	PAFZZ	5310-00-449-2376	80205	MS21245-8	. NUT,SELF-LOCKING,HE UOC: CT1,TC1	1

END OF FIGURE